



BMW E36 Carbon Fiber Wing Installation Instructions



Proper service and repair procedures are vital to the safe, reliable operation of all motor vehicles as well as the personal safety of those performing the repairs. Standard safety procedures and precautions (including use of safety goggles and proper tools and equipment) should be followed at all times to eliminate the possibility of personal injury or improper service which could damage the vehicle or compromise its safety.

INSTALLATION NOTES

- **RH** refers to the *passenger side* of the vehicle.
- **LH** refers to the *driver side* of the vehicle.
- Always use the proper torque specifications.
- If applicable to this installation, torque specifications will be listed throughout the document and at the end as well.
- Please read all of these instructions and familiarize yourself with the complete process **BEFORE** you begin.

GENERAL PREPARATION AND SAFETY INFORMATION

Turner Motorsport cares about your health and safety, please read the following safety information. This information pertains to automotive service in general, and while it may not pertain to every job you do, please remember and share these important safety tips.

- Park your car in a safe, well lit, level area.
- Shut the engine off and remove the key from the ignition switch.
- Make sure any remote start devices are properly disabled.
- **ALWAYS** wear safety glasses.
- Make sure the parking brake is applied until the vehicle is safely lifted and supported.
- Whether lifting a vehicle using an automotive lift or a hydraulic jack, be sure and utilize the factory specified lift points.
- Lifting a vehicle in an incorrect location can cause damage to the suspension/running gear.
- **ALWAYS** support the vehicle with jack stands.
- **ALWAYS** read and follow all safety information and warnings for the equipment you are using.



NEVER get underneath a vehicle that is supported only by a jack, and **ALWAYS** make sure that the vehicle is securely supported on jack stands.

INSTALLING THE CARBON FIBER WING

Step 1: 4mm Hex (Allen) Wrench

Carefully peel back the backing strips on both ends of the double-sided tape strips and fold them over to the side as shown. Install two of the clamping brackets (highlighted in **GREEN**) onto **one side** of the base spoiler, then loosely thread in four of the M5 x 8mm screws (arrows).

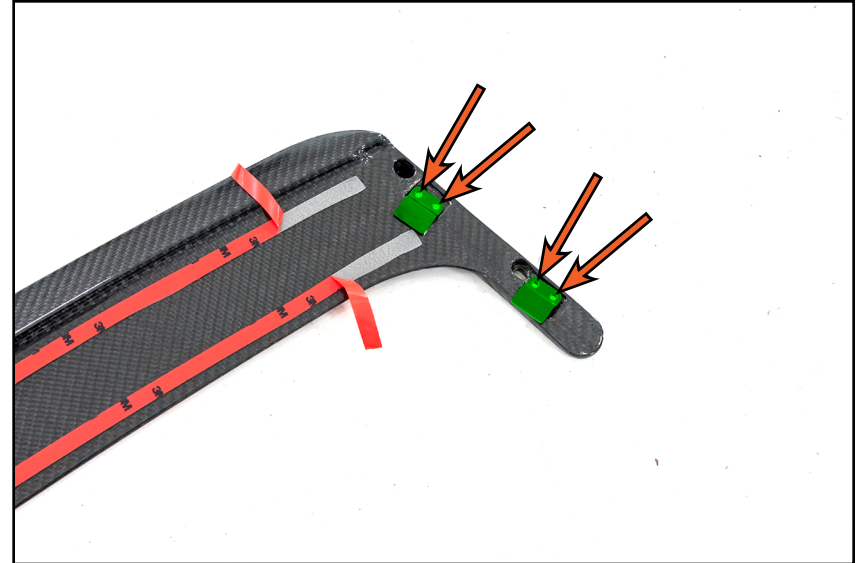

Step 2:

Open the trunk and carefully hook the clamping brackets under the edge of the trunk lid as shown.



INSTALLING THE CARBON FIBER WING

Step 3: 4mm Hex (Allen) Wrench

Carefully lay the spoiler flat onto the trunk surface, ensuring the backing strips remain accessible for removal. Install the two remaining clamping brackets over the edge of the trunk before loosely securing them to the spoiler using the remaining provided M5 x 8mm screws.



Step 4: 4mm Hex (Allen) Wrench

Carefully adjust the spoiler until you are satisfied with the fitment, then adjust the clamping brackets so that they are tight and flush against the trunk surface as shown before tightening the screws until they are fully snug.



CAUTION: Failure to properly adjust the clamping brackets as shown may cause them to contact the rear quarter panels, causing damage.

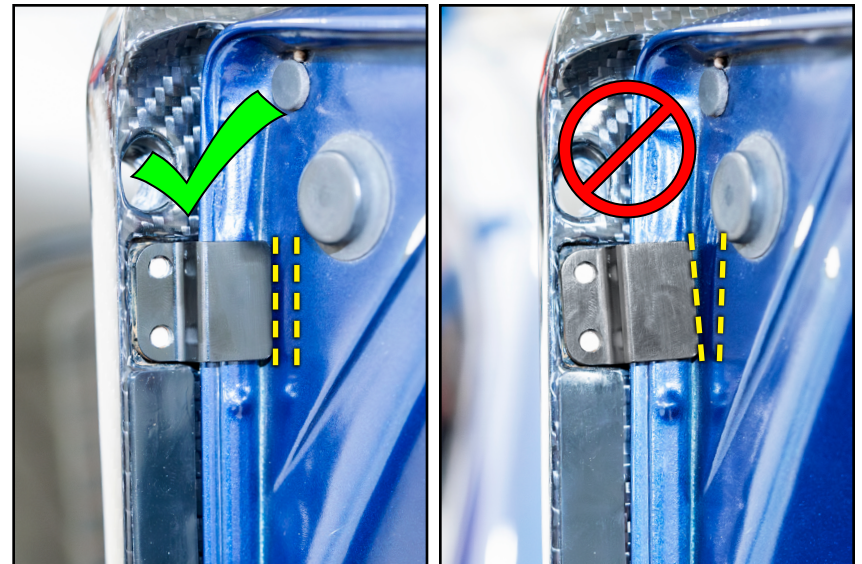

INSTALLING THE CARBON FIBER WING

Step 5:

Carefully remove the backing strips (arrows) from the double-sided tape and push down on the base spoiler to adhere the tape to the trunk.



Step 6:

Optional: A small piece of paint protective film can be added to each rear quarter panel (**YELLOW** dotted lines) for added protection against scratches or scuffs.



INSTALLING THE CARBON FIBER WING

Step 7:

Slide the M6 bolts (M6 x 20mm bolts for wing -OR- M6 x 90mm bolts for wing + optional risers), through the holes in the sides of the base spoiler as shown.



Step 8:

Install the provided gaskets (highlighted in **GREEN**) onto both sides of the base spoiler as shown.

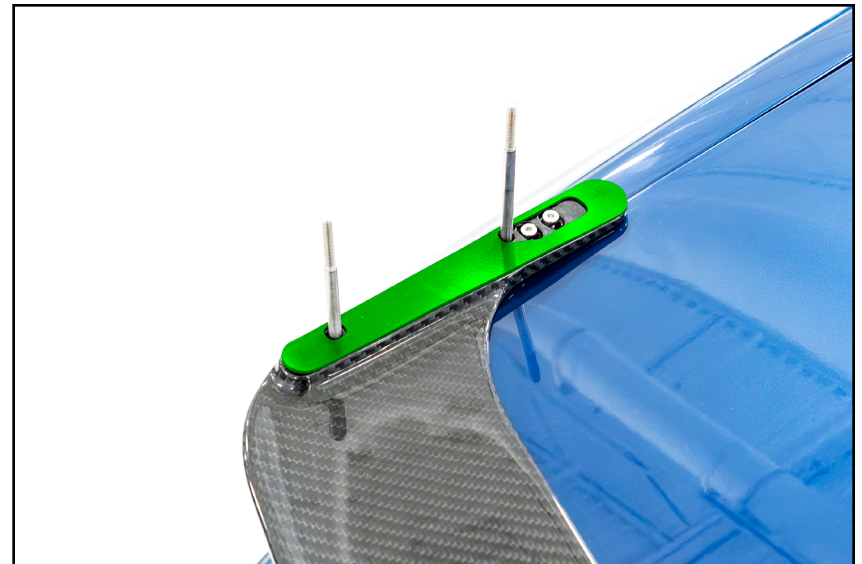

INSTALLING THE CARBON FIBER WING

Step 9:

Optional: Install the riser onto both sides of the base spoiler, then install an additional gasket (highlighted in **GREEN**) on top of each riser.



Step 10: 5mm Hex (Allen) Wrench

Install the wing onto the base spoiler (or risers) as shown, then loosely thread the M6 screws into the threaded inserts in the wing.



INSTALLING THE CARBON FIBER WING

Step 11: 5mm Hex (Allen) Wrench

Carefully adjust the wing until you are satisfied with the fitment, then fully tighten the M6 screws until they are fully snug and the gaskets begin to compress slightly. Install the provided rubber isolators (highlighted in **GREEN**) onto the underside of the spoiler on both sides.



Step 12: 4mm Hex (Allen) Wrench

Optional: Install the gurney flap onto the underside of the wing and secure it with the provided M6 x 8mm screws (arrows), tightening until snug.

Congratulations, your installation is complete!



Your Carbon Fiber Wing installation is complete!



These instructions are provided as a courtesy by Turner Motorsport

Proper service and repair procedures are vital to the safe, reliable operation of all motor vehicles as well as the personal safety of those performing the repairs. Standard safety procedures and precautions (including use of safety goggles and proper tools and equipment) should be followed at all times to eliminate the possibility of personal injury or improper service which could damage the vehicle or compromise its safety.

Although this material has been prepared with the intent to provide reliable information, no warranty (express or implied) is made as to its accuracy or completeness. Neither is any liability assumed for loss or damage resulting from reliance on this material. SPECIFICALLY, NO WARRANTY OF MERCHANTABILITY, FITNESS FOR A PARTICULAR PURPOSE OR ANY OTHER WARRANTY IS MADE OR TO BE IMPLIED WITH RESPECT TO THIS MATERIAL. In no event will Turner Motorsport, Incorporated or its affiliates be liable for any damages, direct or indirect, consequential or compensatory, arising out of the use of this material.