



BMW E36 Ultimate Clutch Pedal Installation Instructions



Proper service and repair procedures are vital to the safe, reliable operation of all motor vehicles as well as the personal safety of those performing the repairs. Standard safety procedures and precautions (including use of safety goggles and proper tools and equipment) should be followed at all times to eliminate the possibility of personal injury or improper service which could damage the vehicle or compromise its safety.

TABLE OF CONTENTS

Installation and Safety Information	pg.3
Removing the Stock Clutch Pedal	pg.4
Installing the New Clutch Pedal	pg.6
Clutch Pedal Adjustment Procedure	pg.9

ASSEMBLY EXPLODED VIEW

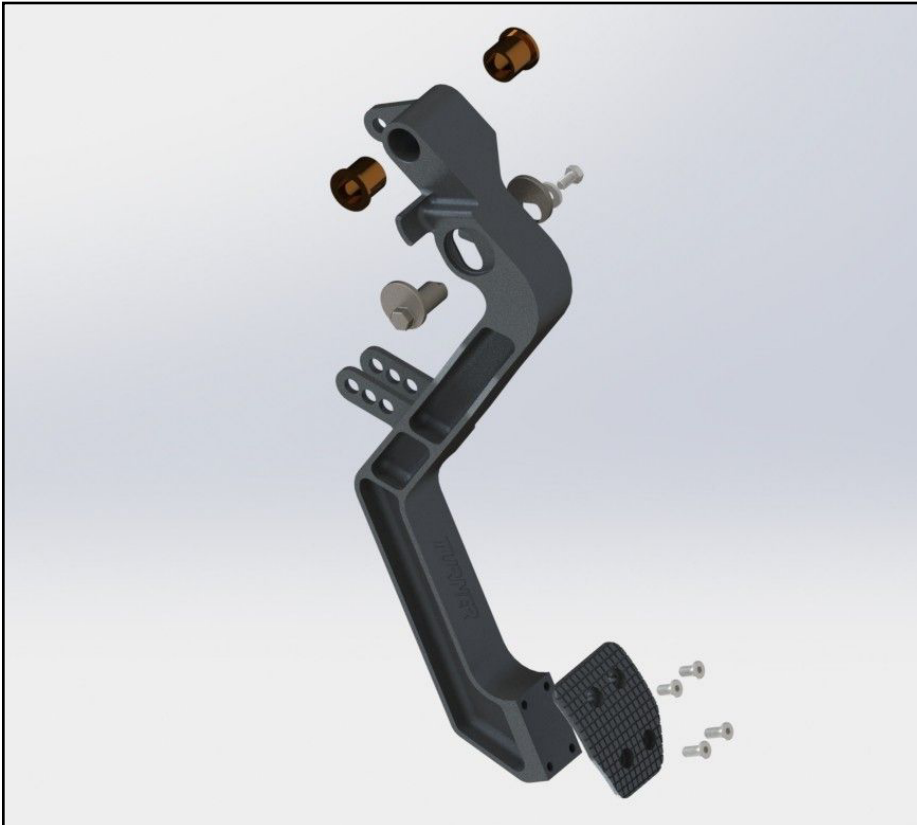

INSTALLATION NOTES

- **RH** refers to the *passenger side* of the vehicle.
- **LH** refers to the *driver side* of the vehicle.
- Always use the proper torque specifications.
- If applicable to this installation, torque specifications will be listed throughout the document and at the end as well.
- Please read all of these instructions and familiarize yourself with the complete process **BEFORE** you begin.

GENERAL PREPARATION AND SAFETY INFORMATION

Turner Motorsport cares about your health and safety, please read the following safety information. This information pertains to automotive service in general, and while it may not pertain to every job you do, please remember and share these important safety tips.

- Park your car in a safe, well lit, level area.
- Shut the engine off and remove the key from the ignition switch.
- Make sure any remote start devices are properly disabled.
- **ALWAYS** wear safety glasses.
- Make sure the parking brake is applied until the vehicle is safely lifted and supported.
- Whether lifting a vehicle using an automotive lift or a hydraulic jack, be sure and utilize the factory specified lift points.
- Lifting a vehicle in an incorrect location can cause damage to the suspension/running gear.
- **ALWAYS** support the vehicle with jack stands.
- **ALWAYS** read and follow all safety information and warnings for the equipment you are using.



NEVER get underneath a vehicle that is supported only by a jack, and **ALWAYS** make sure that the vehicle is securely supported on jack stands.

REMOVING THE STOCK CLUTCH PEDAL

Step 1: Flat Head Screwdriver

Depress the clutch pedal, then remove the clip (arrow) which secures the input cylinder pin in place. Do not release the clutch pedal.

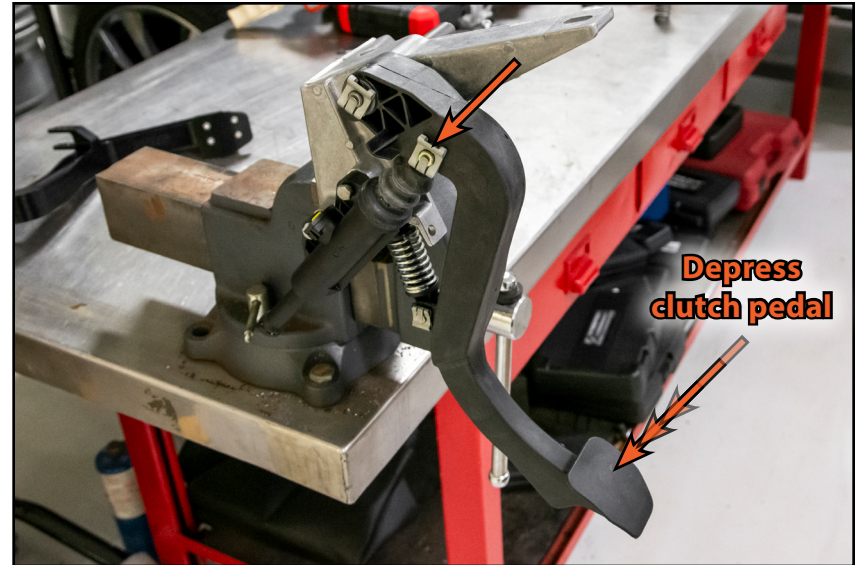

Step 2: Flat Head Screwdriver

While maintaining pressure on the clutch pedal, slide the input cylinder pin (arrow) out of the pedal.

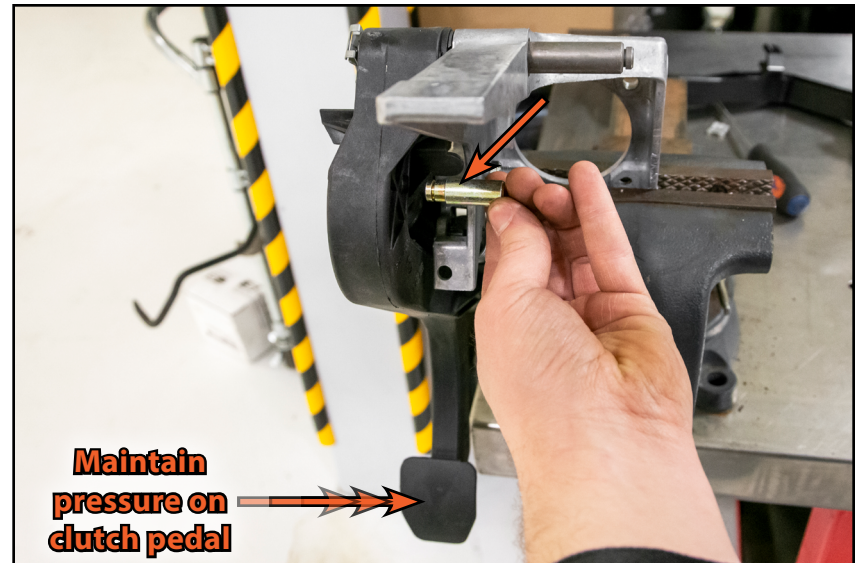

REMOVING THE STOCK CLUTCH PEDAL

Step 3: Flat Head Screwdriver

SLOWLY release the tension on the clutch pedal then remove the clip and pin (arrow) securing the spring assembly (highlighted in **RED**) to the pedal. Set the spring assembly aside.

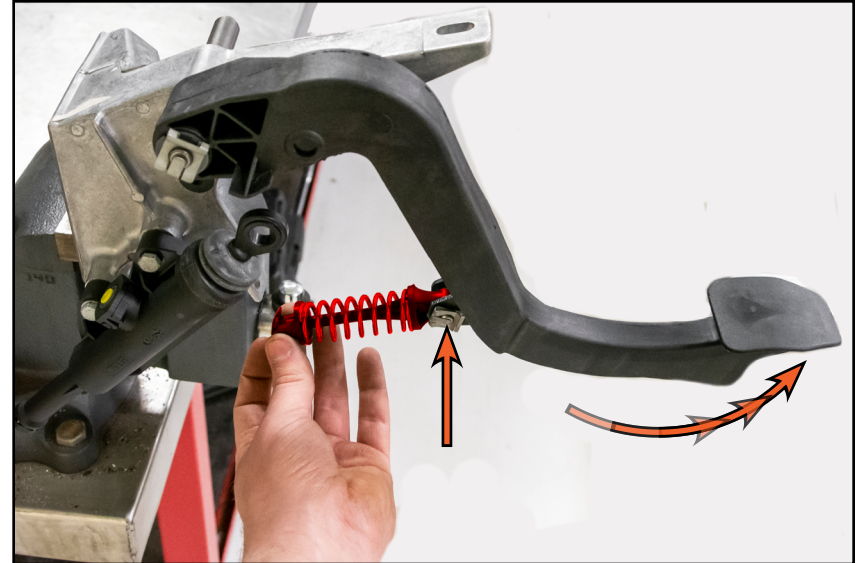

Step 4: Flat Head Screwdriver

Remove the clip (arrow) which secures the pedal in place, then slide it off the rod on the pedal bracket.

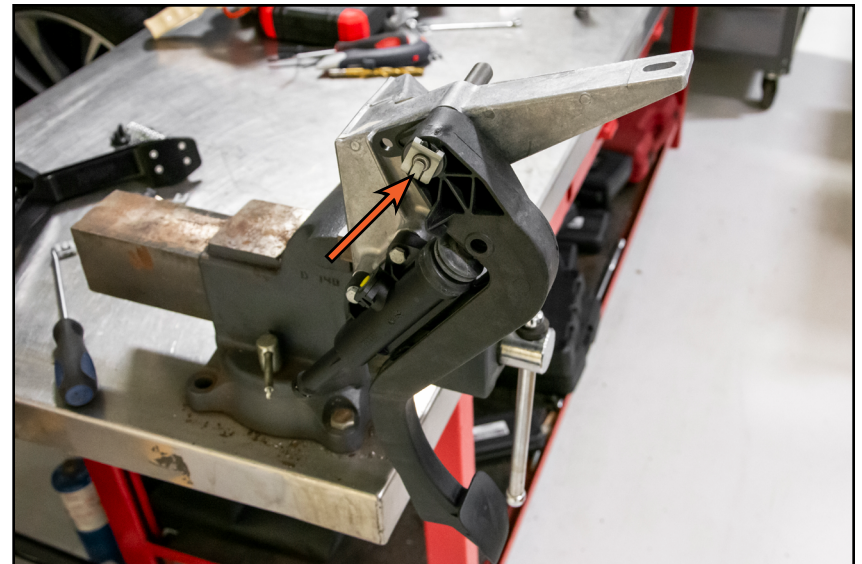

INSTALLING THE NEW CLUTCH PEDAL

Step 1: 8mm Socket & Ratchet

Remove the screw, flat washer, and eccentric washer (arrow), then slide the eccentric bolt out from the new pedal assembly.



Step 2:

Slide the new pedal onto the rod on the pedal bracket as shown.



INSTALLING THE NEW CLUTCH PEDAL

Step 3:

Install the spring assembly onto the pedal, select the desired setting, then slide the pin into place and install the clip.



Please reference [page 9](#) for information regarding the spring adjustment settings.

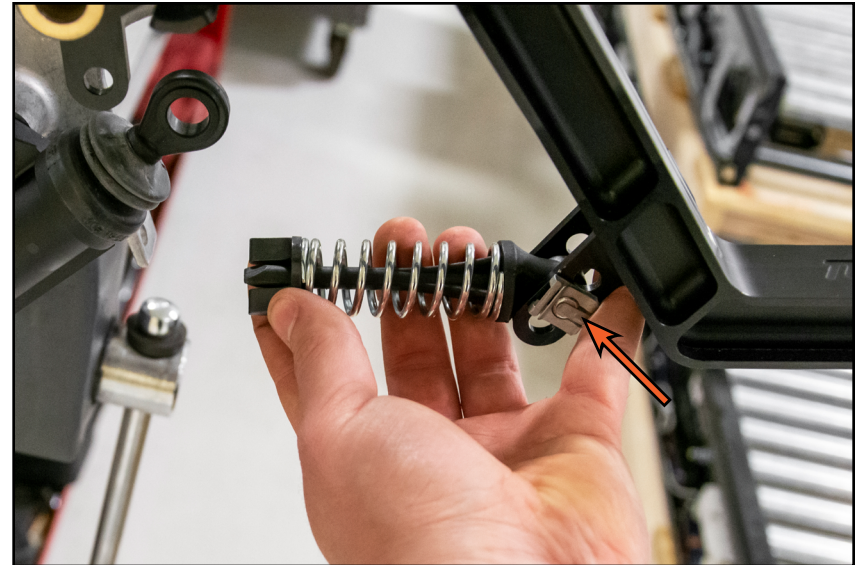

Step 4: Flat Head Screwdriver -OR- 6mm Socket & Ratchet

Ensure the spring assembly is assembled correctly (as shown in inset photo), then **SLOWLY** depress the clutch pedal and guide the spring into place so that the upper plastic tabs sit in the corresponding notches in the pedal bracket with the small metal clip sandwiched between. **DO NOT** release the clutch pedal yet.



The center post of the spring assembly should pass through the opening in the pedal bracket as the pedal is depressed. If you have difficulty depressing the pedal **STOP**, and ensure the spring assembly is properly aligned with the bracket before continuing. Forcing the pedal down can damage or break the spring assembly.

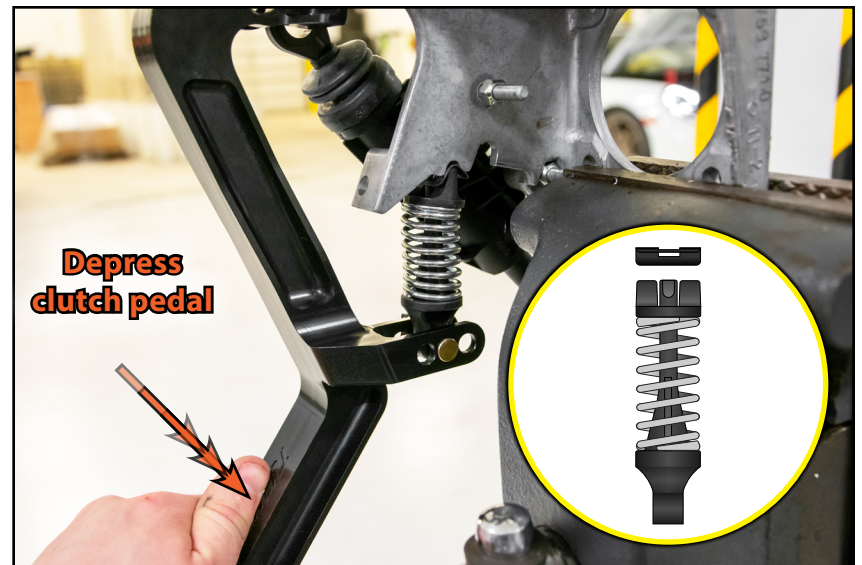

INSTALLING THE NEW CLUTCH PEDAL

Step 5: 8mm Socket & Ratchet

While maintaining pressure on the clutch pedal, slide the eccentric bolt (arrow) through the pedal and input cylinder, then secure it on the other end with the eccentric washer, flat washer, and bolt. Tighten the bolt until snug.



Please reference [page 9](#) for information regarding the input cylinder adjustment settings.

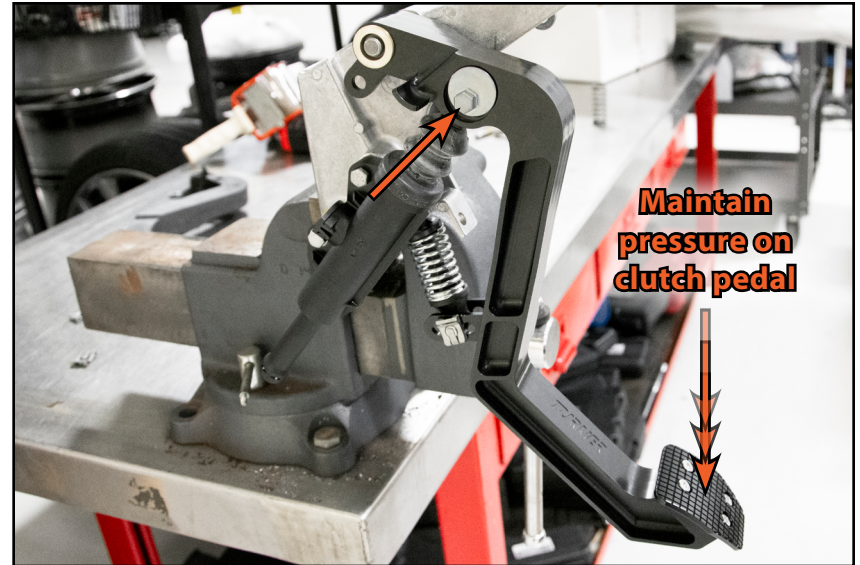

Step 6:

Install the clip (arrow) to secure the pedal to the rod.

Congratulations, your installation is complete!

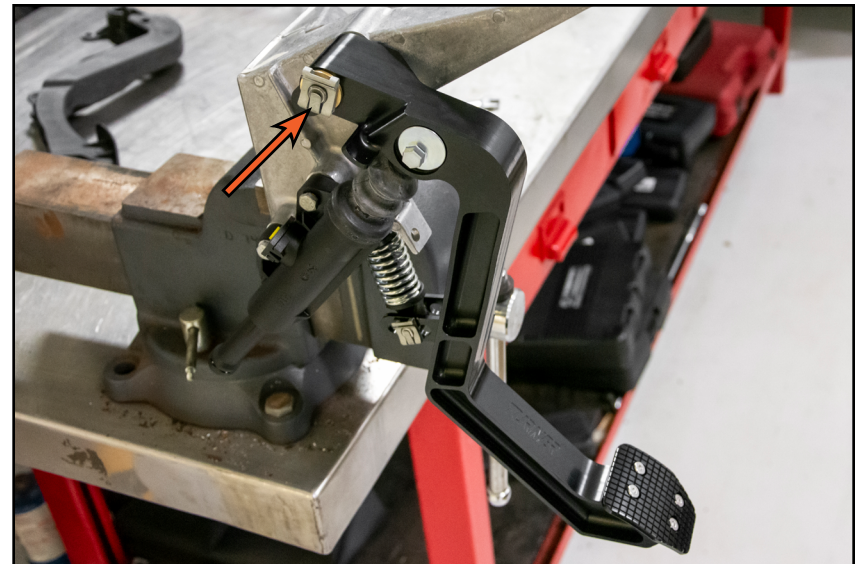

CLUTCH PEDAL ADJUSTMENT PROCEDURE

Spring Adjustment:

Adjusting the angle of the spring will change the point at which you experience spring tension during the clutch pedal's travel.

- Setting 1 (highlighted in **GREEN**) results in a pedal with spring tension felt only at the very top of travel.
- Setting 2 (highlighted in **YELLOW**) results in an OE feel, light spring tension can be felt at the top half of travel.
- Setting 3 (highlighted in **RED**) results in a pedal with spring tension that progressively increases throughout travel.

Input Cylinder Adjustment:

Adjusting the angle of the input cylinder will increase or decrease the amount of leverage you have on the input cylinder.

- Setting 1 (highlighted in **GREEN**) increases the amount of leverage you have, resulting in a lighter pedal feel.
- Setting 2 (highlighted in **YELLOW**) results in an OE feel, with no increase or decrease in leverage.
- Setting 3 (highlighted in **RED**) decreases the amount of leverage you have, resulting in a heavier pedal feel.

Spring Adjustment Range

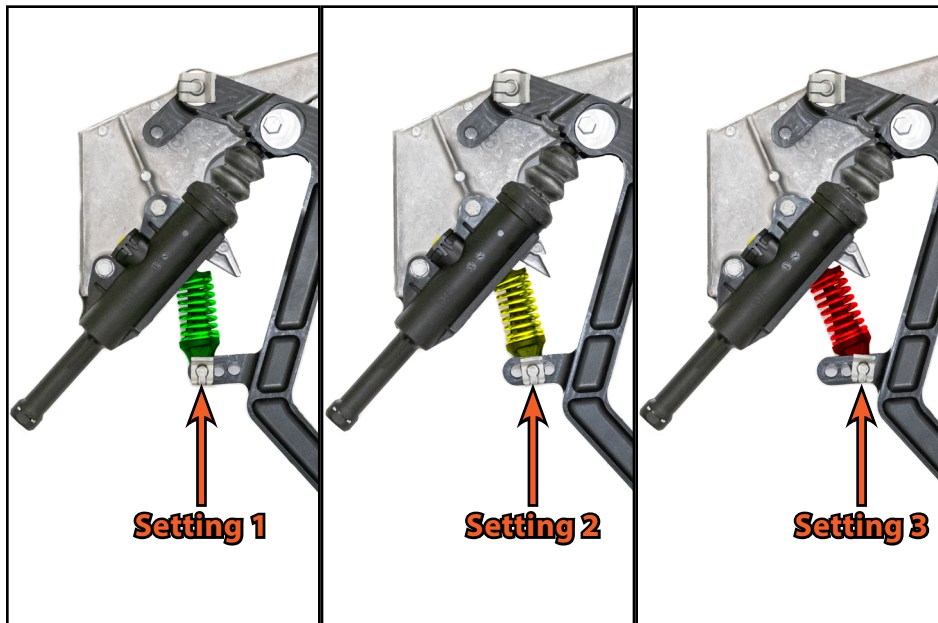

Input Cylinder Adjustment Range

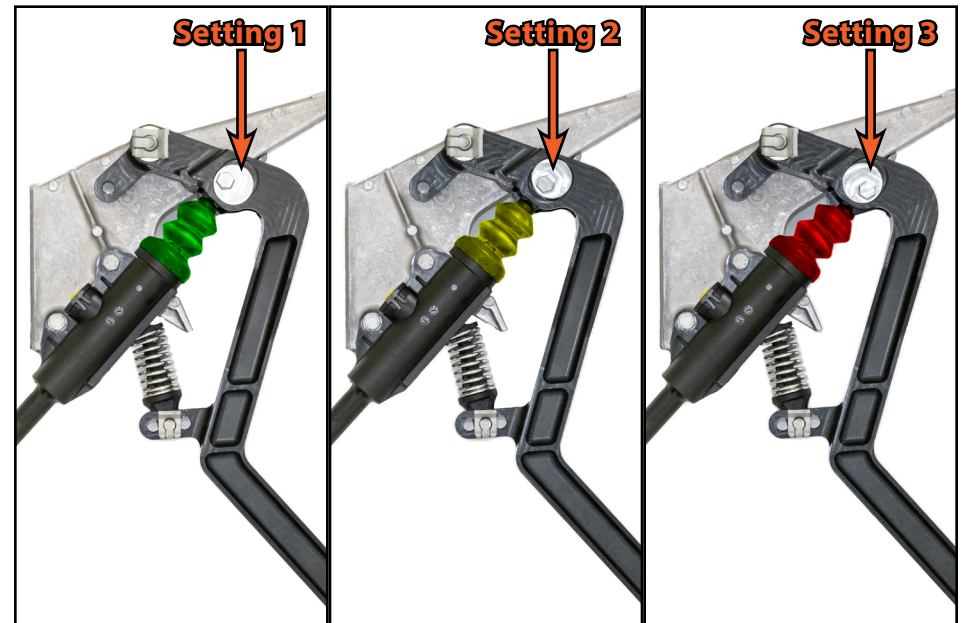

Your Ultimate Clutch Pedal installation is complete!



These instructions are provided as a courtesy by Turner Motorsport

Proper service and repair procedures are vital to the safe, reliable operation of all motor vehicles as well as the personal safety of those performing the repairs. Standard safety procedures and precautions (including use of safety goggles and proper tools and equipment) should be followed at all times to eliminate the possibility of personal injury or improper service which could damage the vehicle or compromise its safety.

Although this material has been prepared with the intent to provide reliable information, no warranty (express or implied) is made as to its accuracy or completeness. Neither is any liability assumed for loss or damage resulting from reliance on this material. SPECIFICALLY, NO WARRANTY OF MERCHANTABILITY, FITNESS FOR A PARTICULAR PURPOSE OR ANY OTHER WARRANTY IS MADE OR TO BE IMPLIED WITH RESPECT TO THIS MATERIAL. In no event will Turner Motorsport, Incorporated or its affiliates be liable for any damages, direct or indirect, consequential or compensatory, arising out of the use of this material.