

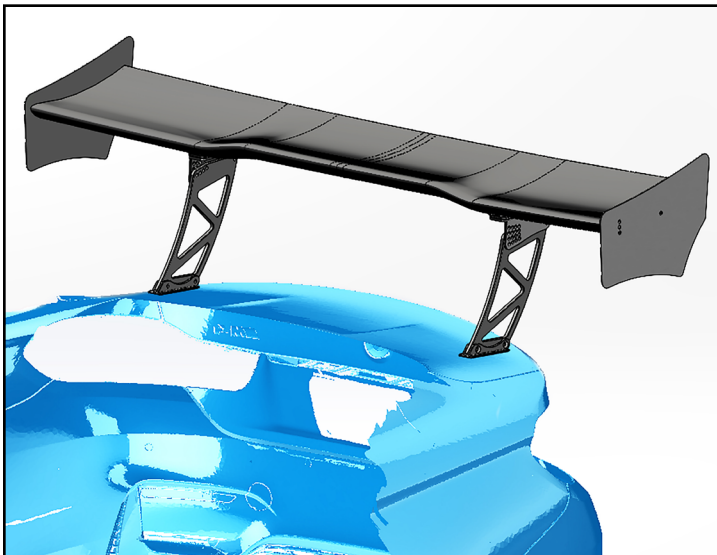

Thank you for purchasing your new Universal Functional Aerodynamic Rear Wing Kit, we appreciate your business!



These installation instructions have been broken up into several sections:

- | | |
|----------------------------------|--------------------------|
| 1) Disassembly | (Page 2) |
| 2) Rear Wing Assembly | (Page 3) |
| 3) Rear Wing Installation | (Page 4) |
| 4) Adjustment Guidelines | (Page 6) |

Section 1: Disassembly

- Step 1**
- Open the trunk and remove any trim panels from inside (**Step 1 Photo**).
 - Isolate or remove wiring harnesses or other obstructions before drilling.
 - Carefully plan where your brackets will sit (**ORANGE** highlights below), make sure that the area is accessible and won't interfere with any OE components.

[Table of Contents](#)

Section 2: Rear Wing Assembly

- Step 1**
- Loosely assemble the wing, brackets, uprights, & base brackets (not shown below).
 - If you need to change the width of the base brackets to avoid interference with something inside the trunk lid you can do either (or both) of the following:
 - Flip the brackets underneath the wing either direction.
 - Install the uprights on either end of the brackets underneath the wing.

Step 1a

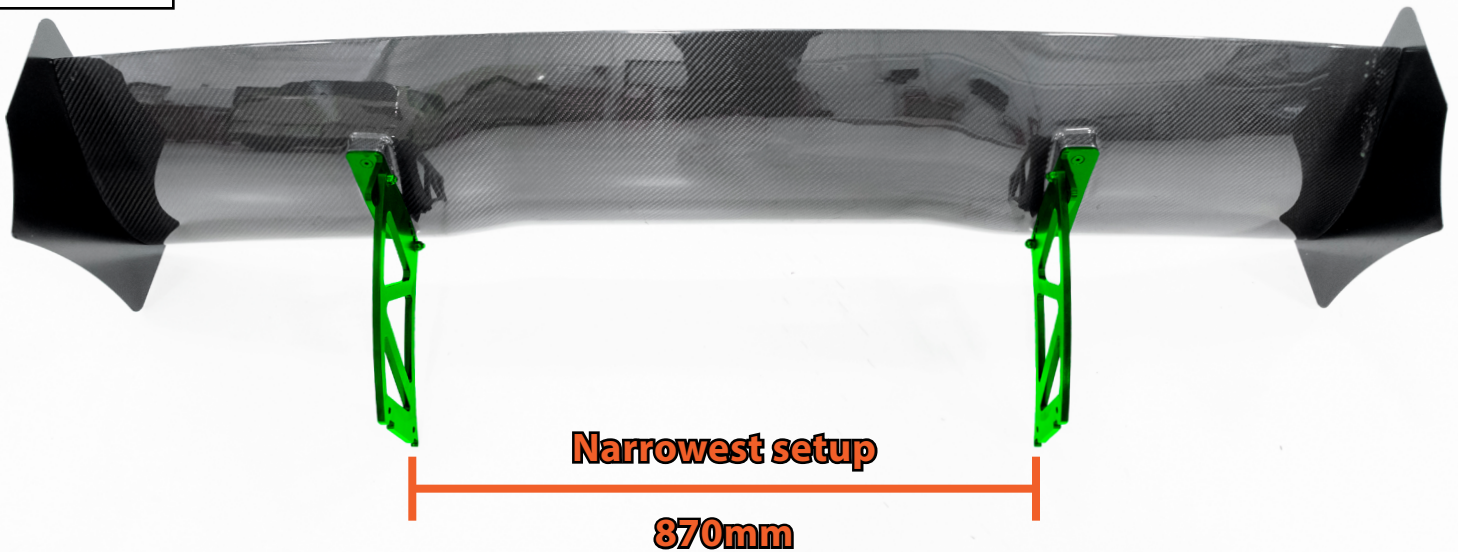

Step 1b



Section 3: Rear Wing Installation

- Step 1**
- Mark the trunk centerline of the trunk lid with masking tape.
 - Measure the distance between the two base brackets on the assembled wing, then divide in half.
 - Measure that distance from the centerline out to where each bracket will be mounted, then mark it with masking tape.
 - Hold the fully assembled wing in place over the locations we just marked, then select the appropriate shim which best matches the contour of the trunk lid (**ORANGE** inset photo).
 - Tape the shims in place (**Step 1 Photo**).
- Step 2**
- Mark the mounting holes on the trunk lid, then flip the shims out of the way (**Step 2 Photo**).
 - **CAREFULLY** drill through the trunk lid using an 8mm drill bit.



Section 3: Rear Wing Installation

- Step 3**
- Remove the base brackets from the wing, then apply RTV around all base bracket and shim mounting holes (**RED** highlights in the **Step 3a Photo**).
 - Mount the base brackets and shims into place using the supplied hardware (**Step 3b Photo**).
 - You may find that you need to modify the inside of the trunk to gain the clearance needed for the large washers provided in the kit. *Do this at your own discretion.*
 - Mount the assembled wing onto the base brackets using the supplied hardware (**Step 3c Photo**).

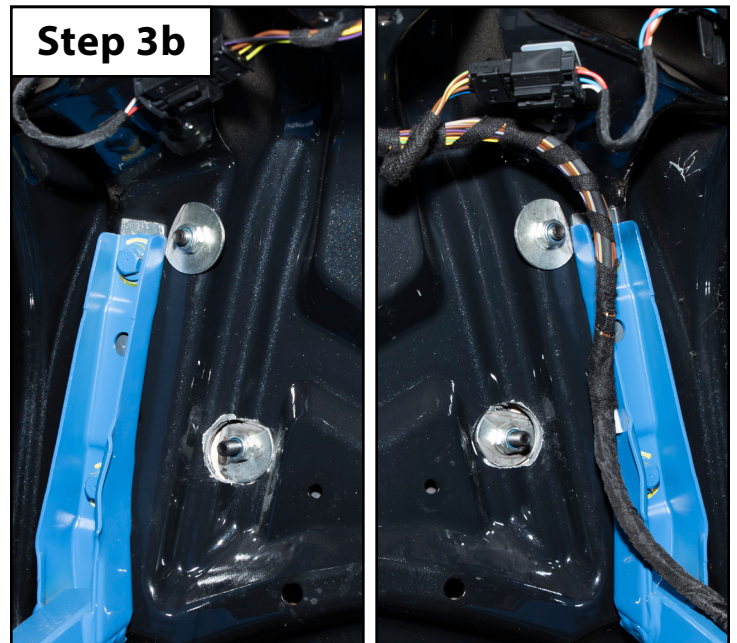
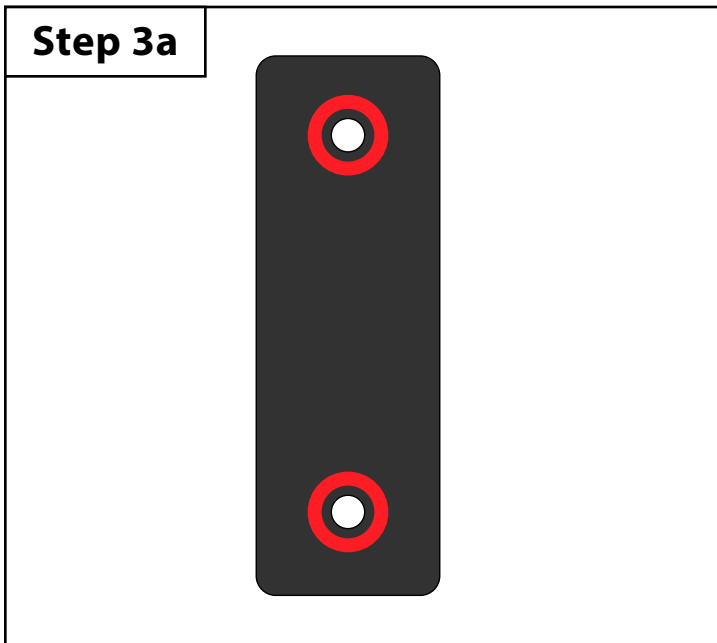

Section 4: Adjustment Guidelines

- Step 1**
- Angle of attack defines the angle at which the wing intercepts the incoming airflow. If you draw an imaginary line between the front and rear edges of the wing (known as the "chord line"), you can clearly see how this angle increases or decreases as you adjust the wing.
 - **A higher angle** increases rear downforce at the expense of increased drag.
 - **A lower angle** decreases rear downforce but will result in less drag.
 - Our wing can be adjusted anywhere from ~0 degrees to ~20 degrees of angle, with each of the 16 mounting holes adjusting by ~1.33 degrees.
 - To adjust the wing, remove the hardware from the front mounting holes, adjust the angle to your desired setting, then reinstall the hardware and tighten until snug.

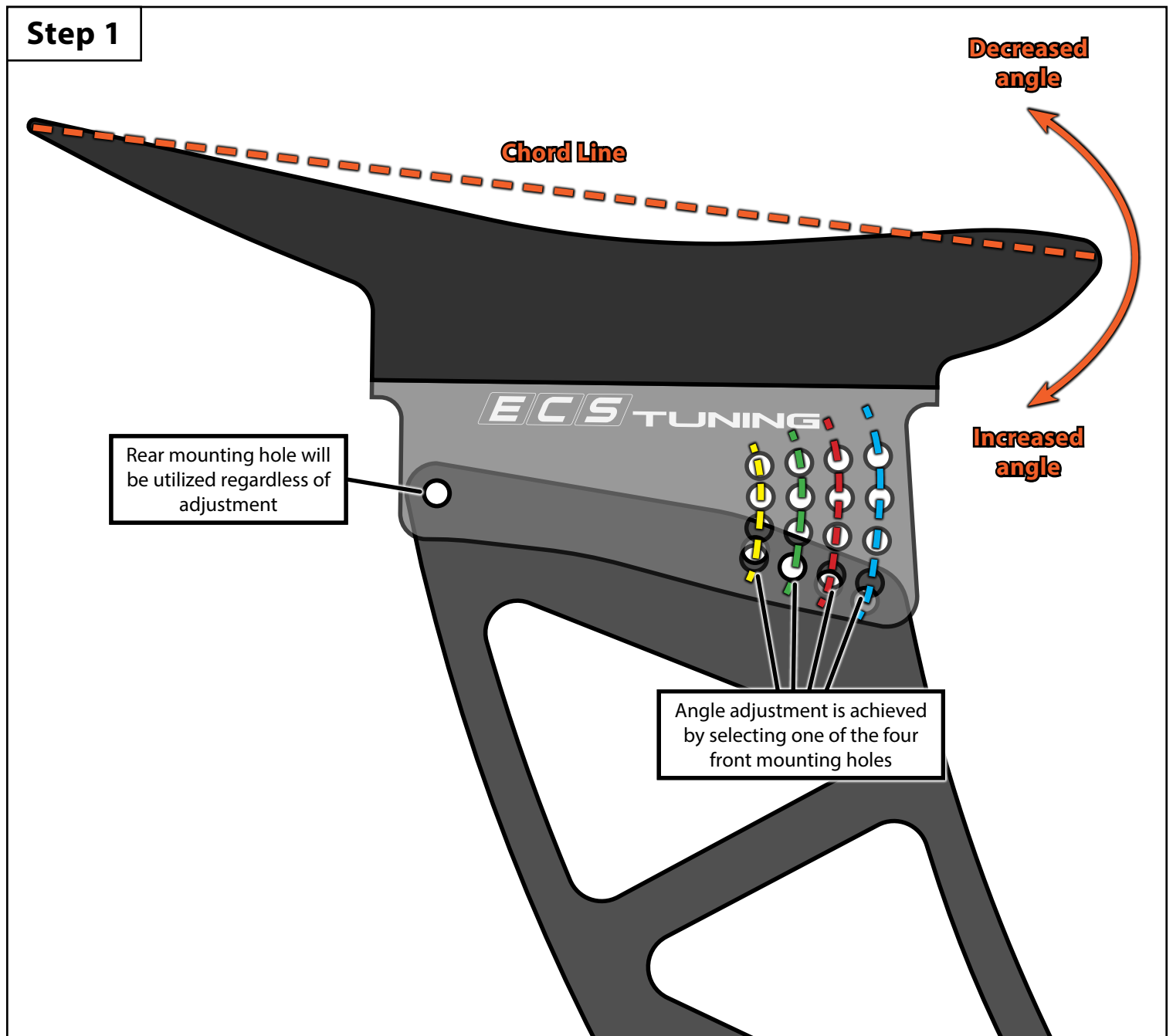

Section 4: Adjustment Guidelines

- Step 2**
- The end plate angle can be adjusted for appearance purposes to compensate for the angle of the wing.
 - To adjust the end plates, remove the hardware from the front mounting holes, adjust the angle to your desired setting, then reinstall the hardware and tighten until snug.

